

# **COVID-19 Protocols & Policies Proposal**

## *Camp Paradise*

### **Overview**

The goal of Camp Paradise for Dads Camp in 2021 is to provide every camper and staff member with a safe and valuable camp experience, without hindering ministry or putting health at risk. To do this, Camp Paradise is adhering to CDC guidelines, seeking wisdom from Willow Creek Community Church, and securing the advice and recommendations of local officials in Luce County, Michigan and the LMAS health department.

The document specifically provides information and policies for Camp Paradise regarding:

- Updated capacity limits
- Mask and PPE requirements
- Cleaning protocols and sanitation guidelines
- Pre-arrival requirements
- Enhanced cleaning practices conducted by staff

Camp Paradise will provide instructional signage and hand sanitizing stations at all activity locations and buildings, with the exception of camper cabins where campers will have their own hand sanitizer. Campers, staff, volunteers, and guests will be required to sanitize their hands prior to entering indoor and designated common areas to ensure the cleanliness of people and equipment, especially during Dads Camp sessions.

Additionally, Camp Paradise is limiting the capacity for each Dads Camp session, requiring face masks indoors or whenever 6-foot distance isn't possible, encouraging physical distancing of 6-feet or more unless participants are with their family unit, providing guidance for sleeping head-to-toe, and leaving windows open in cabins, and clearly communicating health screening questions prior to and upon arrival at Dads Camp.

Regular reminders about social distancing, mask-wearing, and frequent sanitizing will be provided daily by Camp Paradise staff during meal times and activities. Instructional signage posted throughout the camp will reinforce messaging about COVID-19 policies and guidelines.

For Spring and Fall Work Weeks, Camp Paradise will employ the applicable protocols and policies in this document to help ensure that volunteers and staff remain safe and healthy.

### **Capacity Limits**

In an effort to create a safe space and mitigate the spread of COVID-19, Camp Paradise aims to fill Dads Camp up to 60% capacity. This capacity limit follows the three-household protocol, making it possible to place three family units per cabin and per meal table in the dining hall. It also allows the combination of campers and summer staff team to remain below a 100 person

capacity threshold at both the Dining Hall and Chapel. The total number of campers arriving at Dads Camp each session will be limited to 72 persons or less, in addition to the approximately 30-person summer staff team (full-time, part-time, and seasonal staff).

### **Mask Policy**

Face masks or coverings are to be worn both indoors and outdoors when unable to physically distance (6-feet or more). Masks are required indoors and will be given to participants that don't have one. The Camp Paradise summer staff team will be provided with reusable masks and replaceable filters, as well as have access to disposable masks as needed.

### **Pre-Arrival Requirements and Health Screenings**

Prior to arriving at Camp Paradise, campers, staff, and volunteers are required to complete the Willow Creek Community Church pandemic waiver. Additionally, campers will be required to complete a COVID-19 symptom and screening questionnaire 72 hours prior to departure for Camp Paradise. A staff member will confirm screening questions upon camper arrival in the parking lot.

Should a camper arrive at the Camp Paradise parking lot feeling ill or any symptom of COVID-19, they will be quarantined in an isolated cabin overnight with dinner delivered to them. If they are still experiencing symptoms, they will go home in the morning.

### **Enhanced Cleaning**

Camp Paradise consistently maintains a high standard of care and cleanliness across all of its facilities and equipment. Due to the risks associated with the current pandemic, Camp Paradise will implement supplemental cleaning practices specifically designed to mitigate the spread of COVID-19 among campers and staff. All buildings, common areas, and high touch surfaces/equipment will be cleaned and sanitized thoroughly prior to each Dads Camp session. Main buildings—the lodge, chapel, pavilion, outhouses, and shower houses—will be cleaned daily during Dads Camp. Hand sanitizer and/or disinfectant wipes will be available in most buildings and activity sites for campers and staff to utilize. High-touch surfaces will be cleaned multiple times per day. Activity equipment will be sanitized and/or rotated for use as appropriate.

### **Food Service**

The Kitchen Manager is responsible for providing a safe food preparation and dining experience for staff, campers, and volunteers. All kitchen staff are required to wear masks and gloves when handling food, paying close attention to change gloves regularly to prevent cross-contamination

of foods. Surfaces, especially high traffic areas, must be cleaned and sanitized daily. Staff working the food pass-through window during meal times must wear a mask and gloves.

To prevent self-serve beverage service, a Camp Paradise staff member will be stationed at the coffee cart as a barista to dispense coffee and hot chocolate. This staff member is required to wear a mask and gloves and be mindful to not touch cups or mugs to the urn/cambro spigot. They are also responsible for cleaning and sanitizing the coffee cart, cambros, and urns before and after each shift.

If a kitchen staff begins experiencing any symptoms, they must stay out of the kitchen and buildings other than their cabin until they receive a negative COVID-19 test result or the symptoms subside.

## **Protocols by Site**

### Dining Hall

Tables in the dining hall will be spaced at least 6 feet apart. Seating will be assigned by cabin group so that no more than 6 people from 3 family units (households) per table. Campers, staff, and volunteers must sit only with their cabinmates. Masks are required in the dining hall when not seated at tables to eat or drink. Participants will be served by kitchen staff or be given pre-packaged meals.

### Chapel

Seating in the chapel will be arranged as pairs of chairs spaced 6 feet apart for campers. Staff will sit in the loft area. Masks are to be worn at all times, with the exception of the speaker(s) or worship team. Weather permitting, doors and windows will remain open for increased ventilation.

### Climbing Tower & High Ropes Course

Safety is Camp Paradise's top priority at the Climbing Tower and High Ropes Course. This year's higher safety standards include keeping participants' hands clean in addition to the activity equipment and individual gear. Hand sanitizer will be available at each element and required for use of equipment. Staff must wear masks when unable to keep a 6-foot distance from campers and when harnessing campers up, clipping campers into elements, belaying, or sleigh driving. High Ropes Course staff should wear their masks at all times unless all campers are on a different level. Campers must wear masks when being hooked into elements but can release their mask while climbing.

### Longhouse

All participants in the Longhouse are required to wear masks and physically distance (6-feet or more). In most weather conditions, all windows will remain open during Dads Camp sessions. Campers will sit with their cabin mates at designated tables. Staff are responsible for cleaning high-touch areas and supplies regularly. Hand sanitizer will be provided at both entrances.

### Archery/BB Range

Campers are required to wear a mask while shooting a bow or bb gun. Physical distancing of 6-feet or more will be encouraged at all times unless a child is with their family unit or cabin mates. Staff assigned to run the site must wear their mask when unable to remain physically distant. To aid in keeping the equipment clean, hand sanitizer will be available and required to use before shooting. Staff will sanitize all equipment and high-touch areas as part of closing down the site.

### Common Areas

Masks are required in outdoor common areas unless a physical distance of 6-feet or more can be maintained or participants are with their family unit or cabin mates.

### Pavilion & Popp's General Store

The Pavilion will be cleaned and sanitized daily, including high-touch surfaces and equipment. All three walls of windows will remain open as usual for ventilation. Campers are encouraged to physically distance (6-feet or more) unless with their family unit or cabin mates. Masks are required and hand sanitizer will be available.

While waiting at Popp's General Store, campers are to stand at a 6-foot distance from each other (unless with their family unit or cabin mates). Campers may try on clothing, but if it's not purchased it will be set aside for 24 hours. Staff are required to wear a mask when interacting with campers at the store. High touch surfaces and inventory will be cleaned and sanitized by staff while closing down the site on days Popp's General Store is in use.

## Camper Cabins

To maintain 60% capacity, Camp Paradise will allow up to three family units (households) per cabin.

Camp Paradise Cabin Layout | 2021 Capacity Proposal

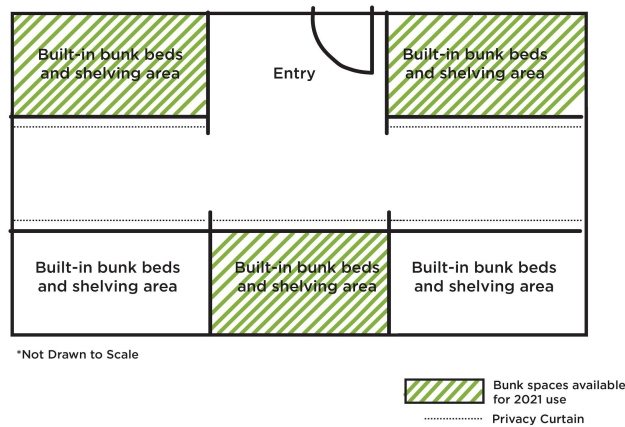

Family units that prefer to tent camp will be permitted to do so and their registered bunks will remain unused. Campers will be instructed upon registration, and via reminder email before their camp session, to bring their own hand sanitizer and sanitize often throughout their stay. Each cabin will be thoroughly cleaned and sanitized prior to each session, and doorknobs and high-touch areas will be cleaned daily during garbage pick-up.

Campers must bunk in the designated bunk spaces to ensure reasonable space between each family unit. Sleeping head-to-toe will be encouraged.

## Shower Houses

Each shower house will be equipped with hand sanitizer and disinfectant wipes for campers to utilize before or after touching the shower buckets, hand pump, and door handles. Staff will clean and sanitize the shower house daily to ensure the limited spread of germs.

## Fire Circle

While at the Fire Circle, we ask all participants to physically distance (6-feet or more) from other family units unless masked. During worship times and gorilla wars, masks must be worn. S'more kits will be provided to each cabin at the start of each Dads Camp session.

### Waterfront

In alignment with the CDC guidelines, masks are not to be worn while swimming at the waterfront. Hand sanitizer will be available at the lifeguard station. The number of people on the water trampolines will be limited to 8 people. Lifeguards will be asked to wear masks if unable to be within 6 feet of campers unless performing a rescue or emergency procedure.

Boats and lifejackets will be cleaned and sanitized each day of operation, as well as after individual use by campers. There will be sanitizing wipes available for campers to use before or after boating.

### Boat Docks & Parking Lot (transition in/out)

During camper arrival and departure, all staff will be required to wear masks. Camper capacity in each boat will be limited to one pair per boat unless masks are worn. Hand sanitizer will be provided at each boat dock and physical distancing (6-feet or more) will be encouraged.

### Staff Areas

Staff areas will have hand sanitizer available at each location and will be cleaned and sanitized regularly. The summer staff team will be treated as a family unit and are not required to wear masks inside their cabins. Head-to-toe sleeping will be encouraged.

## **The 6**

The “6” staff members who work with the kids while dads are in their solitude or small group times are responsible for the safety of the kids, including ensuring COVID-19 policies and physical distancing between cabins.

### Capture the Flag (CTF)

Capture the Flag (CTF) is a staple for the kids’ experience at Dads Camp. Masks should be worn when physical distancing isn’t possible. Hand sanitizer will be available at the medic cabin (or “jail”) for campers and staff to use.

### Craft & Morning Time

Each cabin group of kids should sit at their own table during craft time with no more than 6 people per table. Tables will be spaced out to ensure 6-feet of space between each table.

Masks are to be worn in the longhouse during craft time and hand sanitizer will be available at each entrance. Refer to Longhouse guidelines above for more information.

### **Medical Clinic**

The Camp Paradise medical clinic is a designated building for any first-aid needs, as well as the sleeping quarters for the volunteer medic and their child. The volunteer medic will determine what first-aid can be done under the medical clinic awning as appropriate. Masks must be worn inside the medical clinic by campers. The clinic area must be sanitized after each indoor use. The sleeping quarters will be sanitized after each Dads Camp session. Hand sanitizer and sanitizing wipes will be available at the medical clinic for the volunteer medic and staff to regularly sanitize high-touch areas.

Should campers at Camp Paradise need to quarantine, the old medical cabin will be cleaned and prepared for use. If a staff member needs to quarantine, the new staff cabins will be cleaned and prepared for use.